

MATERIAL AND FINISHES:

- **INSULATOR:**
PBT Glass Filled
UL 94V-0
- **CONTACT:**
Copper Alloy
- **SHELL:**
Steel
- **HOOD:**
Steel
- **PLATING:**
-Contact
1- Gold Flash (Complete)
2- Selective Gold Over Nickel Plated (Contact Area)
Tin/Lead Over Nickel Plated (Tail Area)
-Shell
Nickel over Copper Plated
-Hood
Nickel over Copper Plated

ELECTRICAL CHARACTERISTICS:

- **RATING CURRENT:**
1 Amp.
- **CONTACT RESISTANCE:**
< 25 Milliohm
- **INSULATION RESISTANCE:**
> 1000 Megohm at 500V
- **DIELECTRIC VOLTAGE:**
1000V at 1 Minute
- **OPERATING TEMPERATURE:**
-55°C to +105°C



Female w/Latch Unit: mm

POSITION	A	B	C	D
14F	25.20	36.00	43.90	22.70
24F	36.00	46.80	54.70	33.50
36F	48.90	59.70	67.70	46.60
50F	64.10	74.90	82.80	61.70

Male w/o Latch Unit: mm

POSITION	A	B	C	D
14M	25.50	36.00	43.90	22.70
24M	36.30	46.80	54.70	33.50
36M	49.30	59.70	67.70	46.50
50M	64.40	74.90	82.80	61.70

Female w/o Latch Unit: mm

POSITION	A	B	C	D
14F	25.20	36.00	43.90	22.70
24F	36.00	46.80	54.70	33.50
36F	48.90	59.70	67.70	46.60
50F	64.10	74.90	82.80	61.70

Male-Molded Type Unit: mm

POSITION	A	B	C	D
14M	25.50	29.40	38.50	21.90
24M	36.30	40.20	49.30	32.70
36M	49.30	53.50	62.00	45.80
50M	64.40	68.30	77.40	61.10

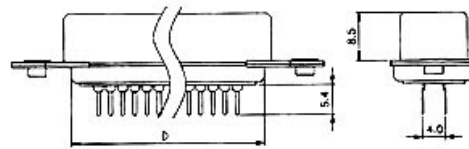
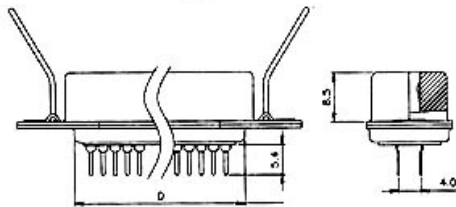
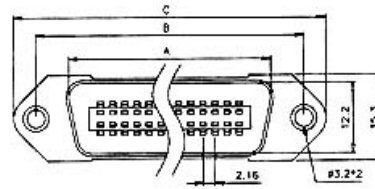
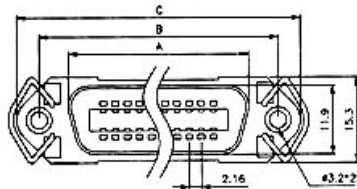

FEMALE W/LATCH

MALE W/O LATCH

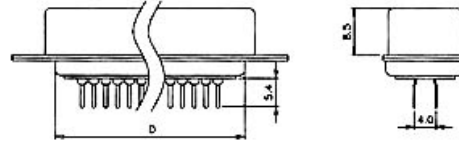
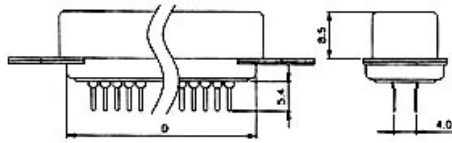
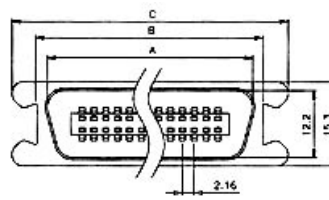
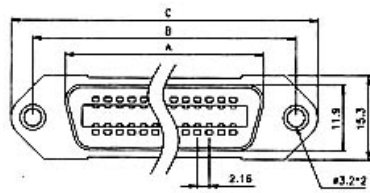

FEMALE W/O LATCH

MALE-MOLDED TYPE

P.C.B. LAYOUT PATTERN:

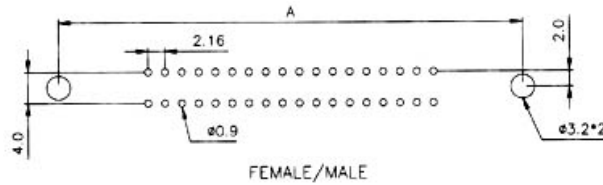

POSITION	A
14M/F	29.40
24M/F	40.20
36M/F	53.50
50M/F	68.30

FEMALE/MALE

HOW TO ORDER:

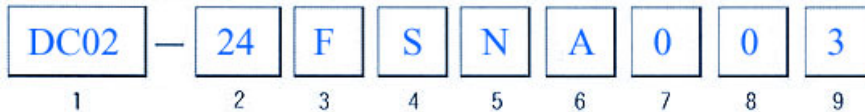

1. Series
DC02

4. Contact Plating
S = Selective Gold
C = 15 μ" Gold
D = 30 μ" Gold

7. Fill with "0"

2. Contact Number
14 24 36 50

5. Shell Plating
N = Nickel

8. Fill with "0"

3. Contact Type
M = Male
F = Female

6. Type Option
A = Panel Type w/o Latch
C = Standard Type w/Latch (Female)
D = Panel Type w/3.8mm Nut Rear Rivet
E = Molded Type (Male)

9. Insulator Color
2 = Blue
3 = Black