

Pro Components

DCS-253-4-W

4 PINS DC POWER CONNECTOR DIP TYPE with SHIELD



SPECIFICATIONS:

Current Carrying Capacity: 20 VDC 7.5A Max.

Dielectric Strength: A potential of 250V RMS, 50/60 Hz shall be applied between any open contacts, for 1 minute without breakdown.

Insulation Resistance: Before any environmental test: 50 MOhms Min. @ 250VDC
After any environmental test: 5 MOhms Min. @250VDC

Contact Resistance: Before any test: 30 mOhms Max. @20 mA, 1Khz
After performance life test: 60 mOhms Max. @20 mA, 1Khz

Insertion Force: 6.0Kg Max.

Withdrawal Force: 0.5-6.0Kg

Performance Test (no load condition): Sockets shall be subject to 1,000 cycles. at the rate of 10 to 20 cycles per minute.

MATERIAL:

- ①-Body: P.B.T. (UL94V-0)
- ②-Cover: P.B.T. (UL94V-0)
- ③-Earth Terminal: BSR-H 0.4t, Tin Plated
- ④-Contact Terminal: BSR-H 0.3t, Tin Plated
- ⑤-Shield: SPCC- 0.4t, Tin Plated

PART NUMBER:

DCS-253-4-W

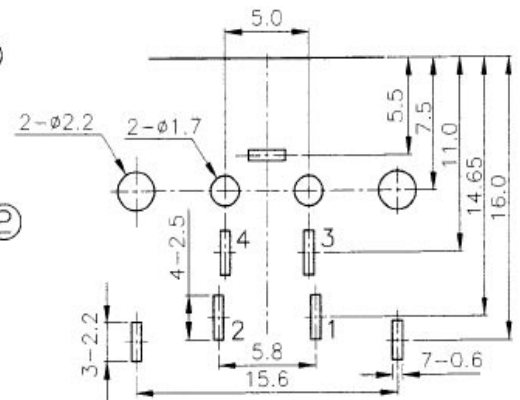
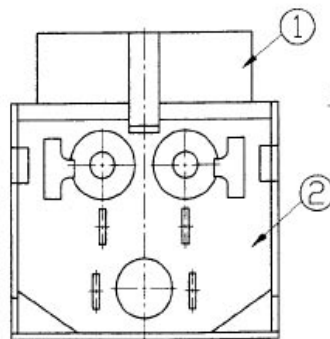
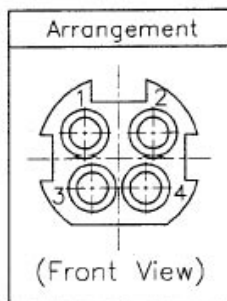
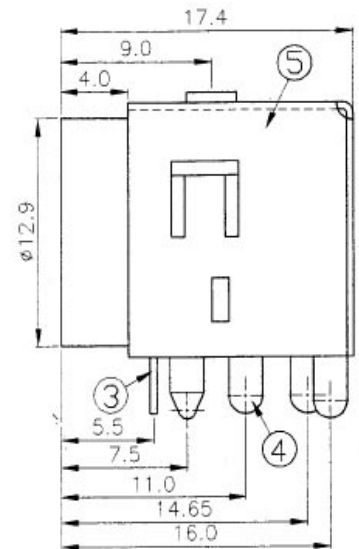
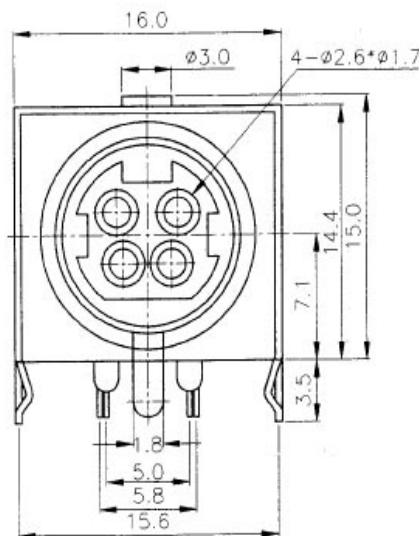

PCB LAYOUT
TOP VIEW

Unless specified, the tolerance is $\pm 0.2\text{mm}$