

# Pro Components

## PRINTED CIRCUIT BOARD QUICK-FIT MALE AND VERTICAL TYPE TERMINALS 4.75MM (0.187") TAB

TAB  
4.75mm  
(0.187")

### MATERIAL:

Contact: Brass  
Plated: Tin  
Thickness: 0.762mm (0.03")  
Mounting Holes: 1.32mm (0.052")

### FEATURES:

Vertical Configuration Type Terminal  
Offers Quick Connecting & Disconnecting of Female  
Terminals  
Pitch 5.08mm(0.200")

### PC QUICK-FIT MALE TYPE TERMINALS 4.75mm(0.187") TAB

UNITS: Inches(mm)

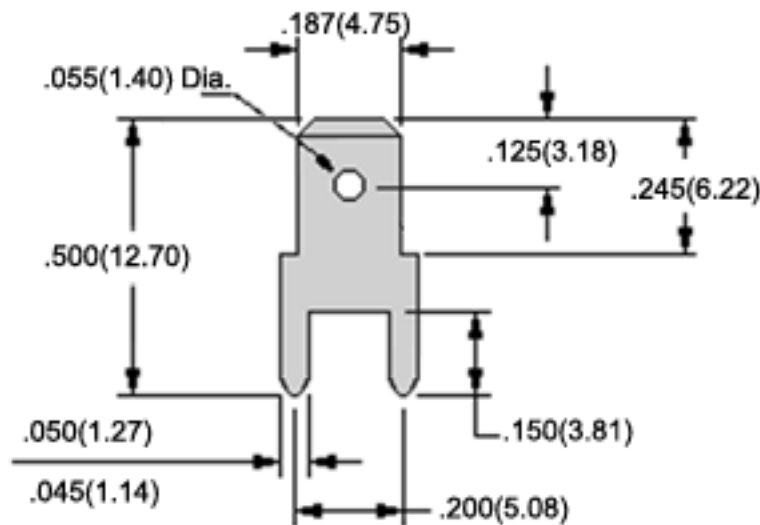

PART NUMBER: PCK-1212